

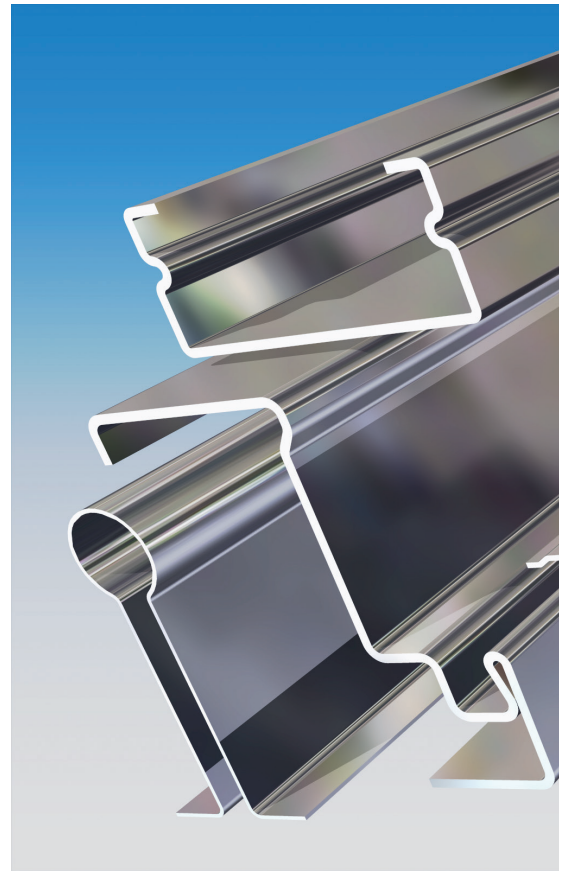

PRECISION PROFILES FOR HARDWARE AND LOCKING TECHNOLOGY

From window shears to door frames for fire doors to running rails for industrial doors – always the right choice

- ✓ Special expertise in stainless steel and cold-rolled strip, also in high-strength grades
- ✓ Widths from 8.5 mm
Wall thicknesses from 0.3 to 4 mm
Lengths from 50 mm to 14 m
(special lengths beyond that)
- ✓ Extensive processing spectrum with many years of experience in profile development for fixture and locking technology
- ✓ In-house processes from design and tool making to production and processing
- ✓ Sector-specific prefabrication:
Bar end machining, countersinking, threading, dome and collar drawing, insertion of weld and punch nuts, piece galvanizing, yellow and blue chromating



APPLICATION EXAMPLES

- » **U and L special profiles** for locking bars
- » **Guide rails** for window shears
- » **Door frames** for fire protection doors
- » **Running rails** for industrial doors
- » **Furniture runners and guide rails**

Advantage: Cost-effective production

- » Cold rolling instead of conventional edge bending
- » Pre-punching and flying punching as inline finishing step
- » Flexible capacities through innovative machinery

voestalpine Präzisionsprofil GmbH

Franz-Tilgner-Str. 10

50354 Hürth

T. +49/2233/6116-0

F. +49/2233/6116-16

<https://www.voestalpine.com/praezisionsprofil/en>



voestalpine

ONE STEP AHEAD.